

PRODUCT LITERATURE

See unit nameplate for manufacturer and address.

503,806M
1/98

USER'S INFORMATION MANUAL

RTG16-120 HEAT ONLY

TP Technical
Publications

Litho U.S.A.

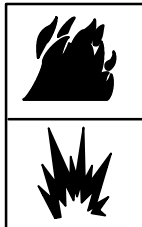
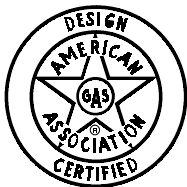

⚠ WARNING

If the information in this manual is not followed exactly, a fire or explosion may result causing property damage, personal injury or loss of life.



Do not store or use gasoline or other flammable vapors and liquids in the vicinity of this or any other appliance.

Installation and service must be performed by a qualified installer, service agency or the gas supplier.

WHAT TO DO IF YOU SMELL GAS:

- Do not try to light any appliance.
- Extinguish any open flames.
- Do not touch any electrical switch; do not use any phone in your building.
- Immediately call your gas supplier from a neighbor's phone. Follow the gas supplier's instructions.
- If you cannot reach your gas supplier, call the fire department.

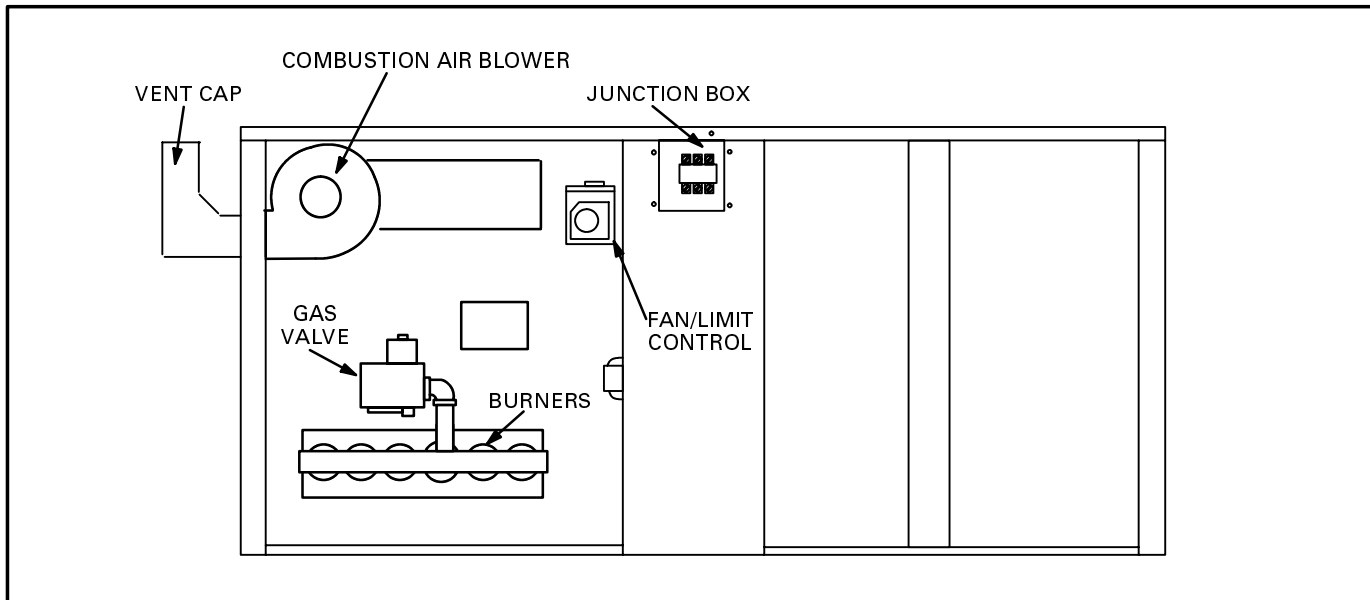

IMPORTANT DIRECTIONS

- 1- Keep furnace area clear and free of combustible materials, gasoline and other flammable vapors and liquids.
- 2- Inspect return air duct to ensure duct is sealed to the furnace and terminates outside the space containing appliance.

! WARNING

Product contains fiberglass wool. Disturbing the insulation in this product during installation, maintenance, or repair will expose you to fiberglass wool. Breathing this may cause lung cancer. (Fiberglass wool is known to the State of California to cause cancer.)

Fiberglass wool may also cause respiratory, skin, and eye irritation.

To reduce exposure to this substance or for further information, consult material safety data sheets available from address shown below, or contact your supervisor.

P.O. Box 799900
Dallas, TX 75379-9900

! WARNING



Electric shock hazard. Can cause injury or death. Before attempting to perform any service or maintenance, turn the electrical power to unit OFF at disconnect switch(es). Unit may have multiple power supplies.

! WARNING



Electric shock hazard. Can cause injury or death. Do not use this furnace if any part has been under water. Immediately call a qualified service technician to inspect the furnace and to replace any part of the control system and any gas control which has been under water.

! WARNING



Danger of explosion. Can cause injury or product or property damage. If overheating occurs or if gas supply fails to shut off, shut off the manual gas valve to the appliance before shutting off electrical supply.

UNIT OPERATION

FOR YOUR SAFETY READ BEFORE LIGHTING
BEFORE LIGHTING smell all around the appliance area for gas. Be sure to smell next to the floor because some gas is heavier than air and will settle on the floor.
 Use only your hand to push in or turn the gas control knob. Never use tools. If the knob will not push in or turn by hand, do not try to repair it, call a qualified service technician. Force or attempted repair may result in a fire or explosion.

UNIT OPERATION - Continued

This unit is equipped with an automatic spark ignition system. There is no pilot. In case of a safety shut-down, move thermostat switch to OFF and return the thermostat switch to HEAT. Electro-mechanical thermostat is shown in figure 1. On units with electronic temperature controls, shut main disconnect off and back on to reset ignition control.

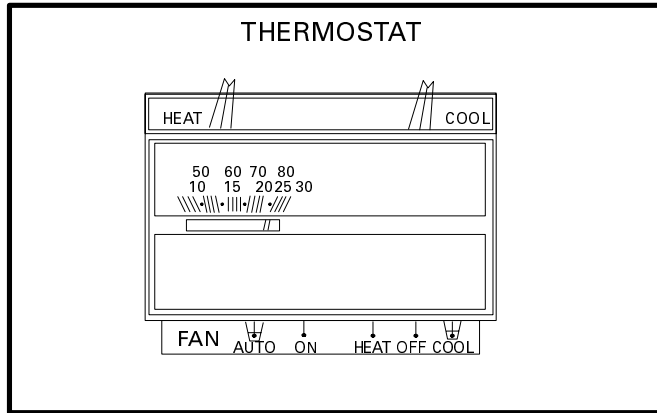



FIGURE 1

A-Placing Unit In Heating Operation

! WARNING

 Danger of explosion and fire. Can cause injury or product or property damage. You must follow these instructions exactly.

- 1- If using electro-mechanical thermostat, set to the lowest setting.
- 2- Turn off all electrical power to appliance.
- 3- This appliance is equipped with an ignition device which automatically lights burner. Do not try to light burner by hand.
- 4- Remove heat access panel.
- 5- Honeywell VR8205 - Turn knob on gas valve clockwise  until it stops. Depress knob and turn clockwise  to OFF.
White Rodgers 36E - Turn knob on gas valve 180° either way to OFF.
- 6- Wait five minutes to clear out any gas. If you then smell gas, STOP! Immediately call your gas supplier from your neighbor's phone. Follow the gas supplier's instructions. If you don't smell gas go to next step.

Gas Valve Operation (Figure 2)

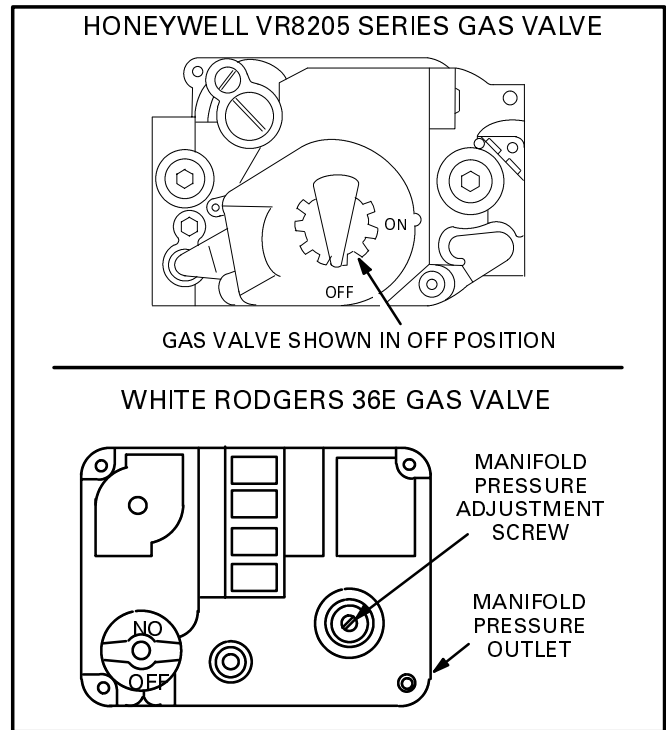





FIGURE 2

- 7- Honeywell VR8205 - Turn knob on gas valve counterclockwise  until it stops. Allow knob to pop up and continue counterclockwise to ON position.
White Rodgers 36E - Turn knob on valve 180° either way to ON.
- 8- Replace heat section access panel.
- 9- Turn on electrical power to unit. If using electro-mechanical thermostat, set to desired setting.
- 10-The combustion air blower(s) will start. The burners will light within 40 seconds.
- 11-If unit does not light first time (gas line not fully purged) it will attempt up to two more ignitions before locking out.
- 12-If lockout occurs, repeat steps 1 through 10.
- 13-If the appliance will not operate, follow the instructions "To Turn Off Gas To Unit" and call your service technician or gas supplier.

B-To Turn Off Gas To Unit

- 1- If using electro-mechanical thermostat, set to the lowest setting.
- 2- Turn off all electrical power to unit if service is to be performed.
- 3- Remove heat section access panel.
- 4- Turn knob on Honeywell gas valve clockwise  until it stops. Depress knob and turn clockwise  to OFF. Turn knob on White Rodgers 180° either way to off. Do not force.
- 5- Replace heat section access panel.

| | |
|--|---|
|  WARNING | |
|  | Danger of explosion. Can cause injury or death. Do not attempt to light manually. Unit has a direct spark ignition system. |

FLUE PASSAGE AND VENT INSPECTION

Annually, before heating season, inspect combustion air louvers, vent cap, heat exchanger, burners and combustion air blower for corrosion, deterioration or deposits of debris. Remove any obstructions or blockage.

BURNER FLAME

| | |
|--|---|
|  WARNING | |
|  | Danger of explosion and fire. Can cause injury or product or property damage. Periodically inspect burner flame to ensure proper unit operation. |

The primary air is permanently set for normal operation. The flame will be basically blue with some clear yellow streaking in the end of the flame. Inspect burner flame periodically during heating season using inspection port provided on the burner access panel.

SERVICE

A yearly inspection by a qualified service technician is recommended.

A-Servicing Filter

Filters must be installed in the return air system. Filters should be checked monthly and replaced when necessary. Take note of air flow direction marking on filter frame when reinstalling filters.

NOTE-Filters must be U.L.C. approved or equivalent for use in Canada.

B-Lubrication

All motors are lubricated at the factory. No further lubrication is required.

SERVICE REMINDER

Call a qualified service technician if the unit is inoperative. Before calling, always check the following to be sure service is required:

- 1- Be sure electrical disconnect switches are ON.
- 2- Check room thermostat for proper setting.
- 3- Replace any blown fuses or reset circuit breakers.
- 4- Gas valve should be ON.
- 5- Air filters should not be plugged, limiting air flow.
- 6- Make sure all access panels are in place.